

# Eye Bolt - 24mm

Product code: EB4

Product specification: 24mm

Category: Hangers and brackets

**Key features**

- 24mm Eye Bolts are available for hanging of light services in mining applications.
- Available with a rolled thread M24 x 150mm long to accept a 24mm expansion shell mechanical anchor, or slotted 150mm long x 2.5mm wide to accept a steel wedge
- Inside diameter of eye is 75mm.
- Nominated bolt length is measured from under the eye to the end of the bolt.
- Feed material around eye is lapped back along the bolt shank for a minimum of 50mm before being fillet welded on both sides to AS1554.1-1991.
- Manufactured from mild steel grade material.
- May be supplied galvanized or Obduro coated.

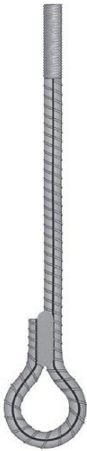

**Product Code Guide**

Bit Type	Drill Diameter	Length	Accessories
EB	4	050	K5

**Notes**

Only Sandvik rock bolt components should be used to enable the optimum performance of the bolt system to be obtained.

Sandvik is Quality Assured to ISO 9001:2015

**Packaging**

Bundles of 10 units or larger quantities on pallets

**Typically, plates used**

Product Group	Plates	Expansion Shell	Wedges
Product Imagery			
Product Code Prefix	OCP	ASES24	WE

**Phone app**

Want to know more; our full product range, knowledge centre, and other details are available via the App; available on iOS and Android devices by searching “Ground Support”.

**Legal disclaimer**

All dimensions, weights, quantities, and specifications are those applicable at the time of this publication and may be amended from time to time. Please contact your local representative for final confirmation of any key specifications.